

Note: use bentonite paste (bentonite with water) on steeper slopes.



construction unit:

Sealing horizontal penetration through Bentofix on slopes

drawing no. :

VE/19-0304-2

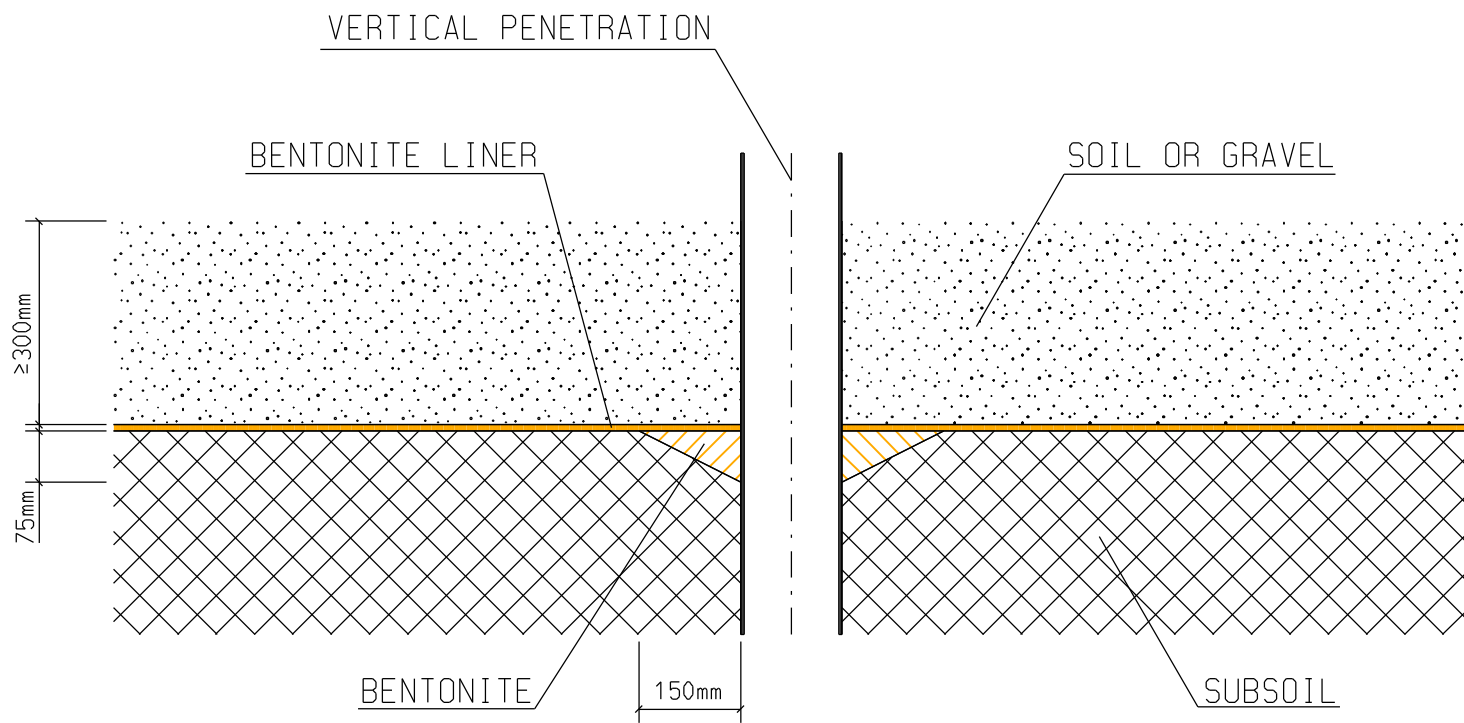

construction unit:

Sealing vertical penetration through Bentofix
installed horizontally

drawing no. :

VE/19-0304-3

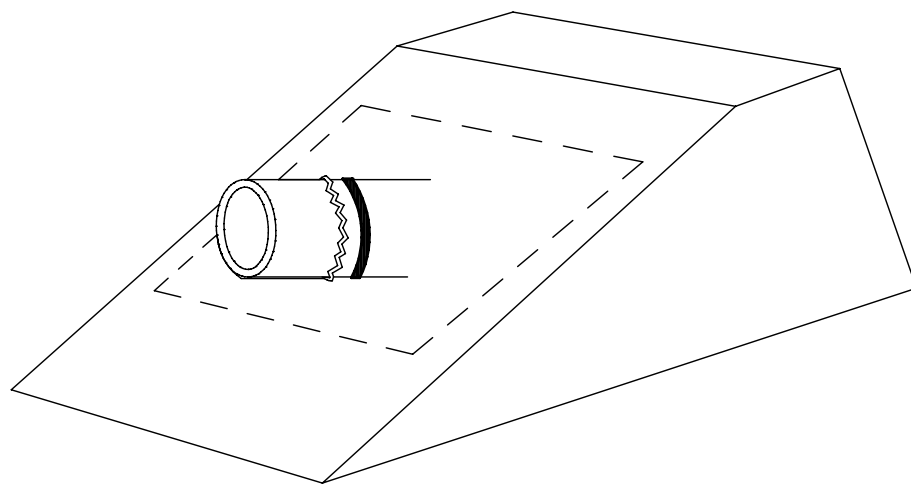
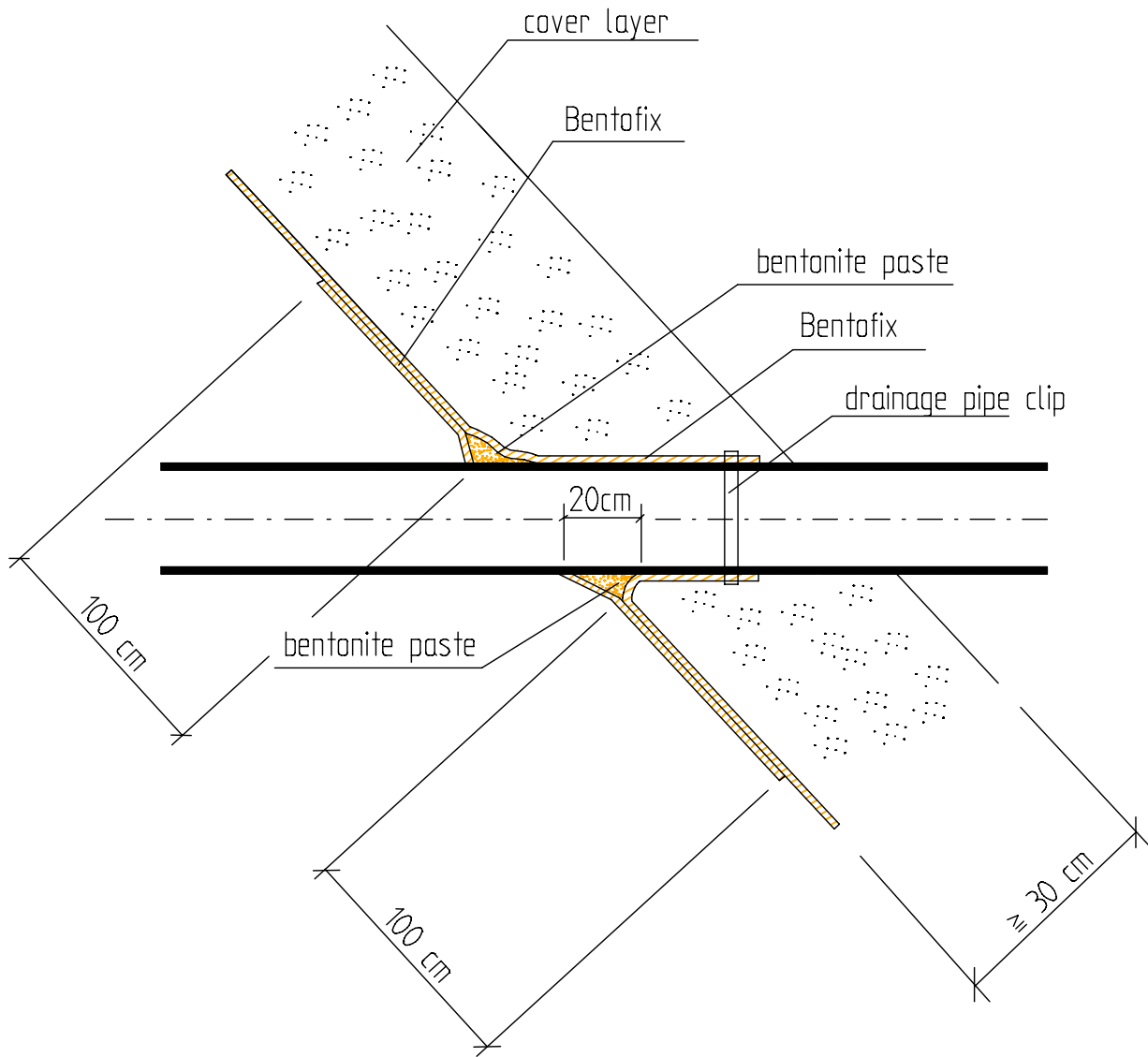

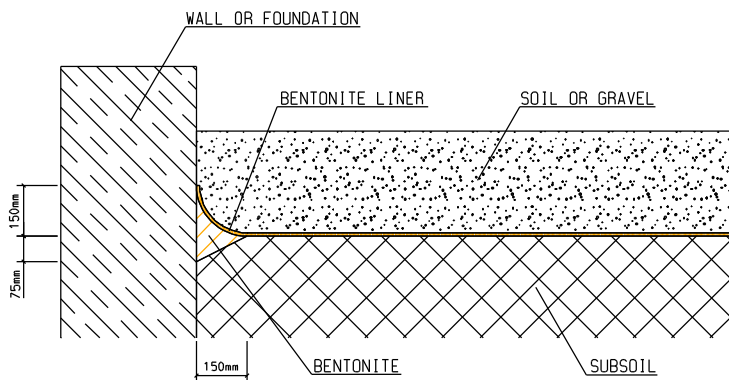
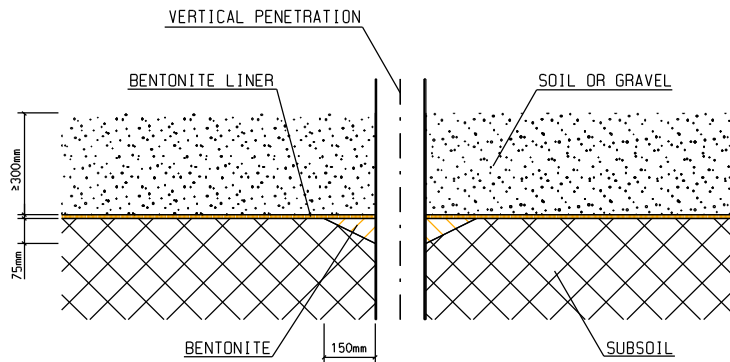
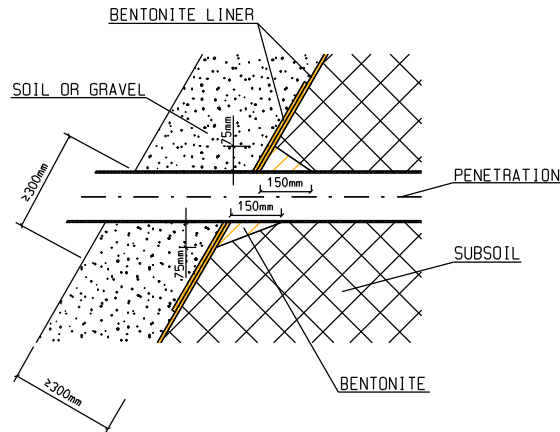
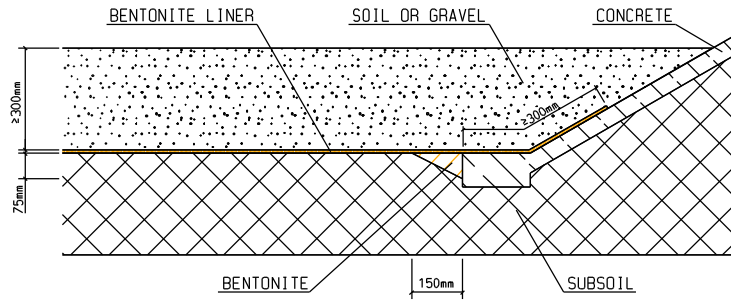

Detail "A 1"

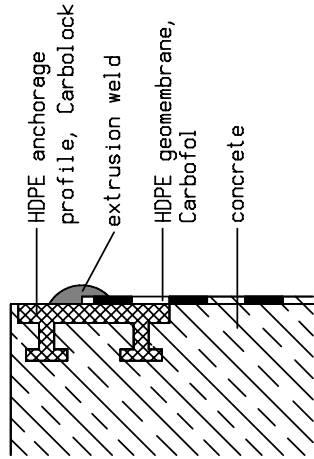

new construction

Detail "A 2"

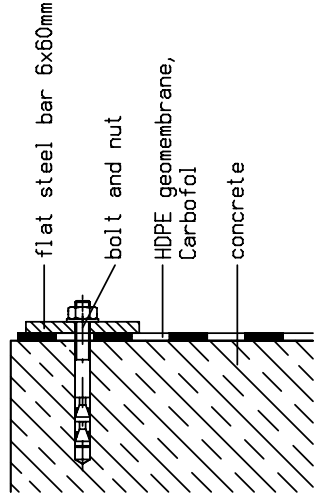

new construction / rehabilitation

Detail "B 1"

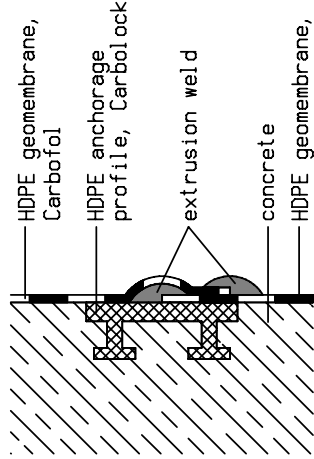

new construction

Detail "B 2"

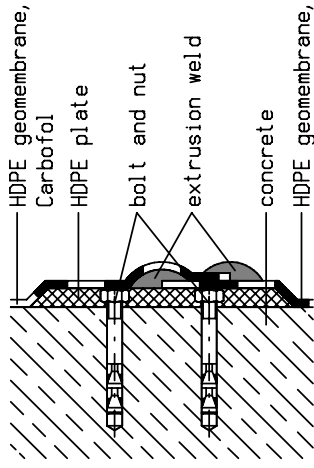

rehabilitation

Detail "A 1-2"

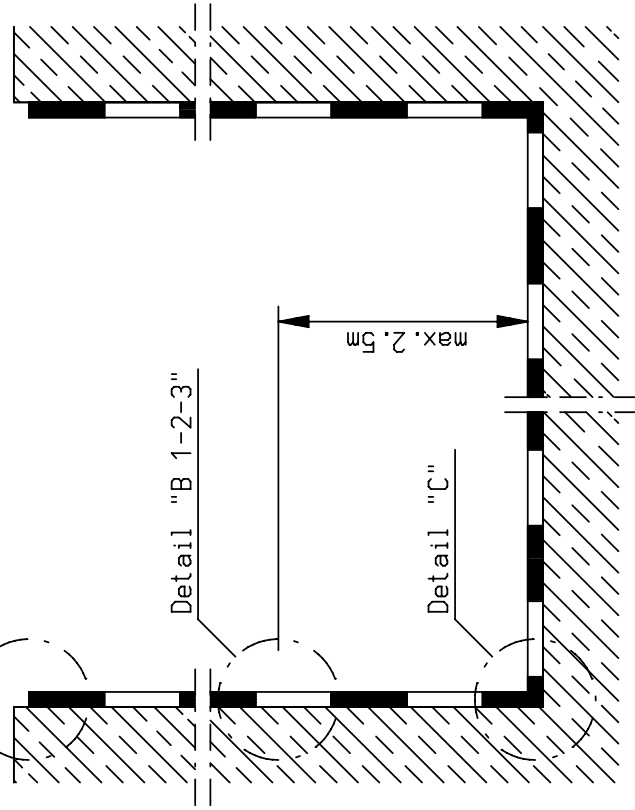

Detail "B 3"

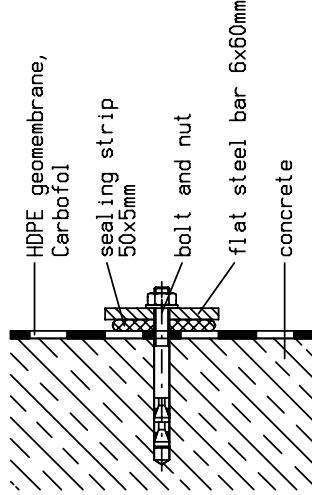

new construction / rehabilitation

Detail "C"

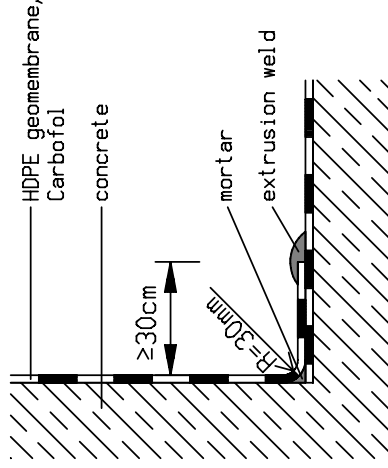

new construction / rehabilitation

Note: The concrete surface must be even and smooth. The horizontal distances between the fixing system must not exceed 2.5m.

construction unit:

drawing no.:

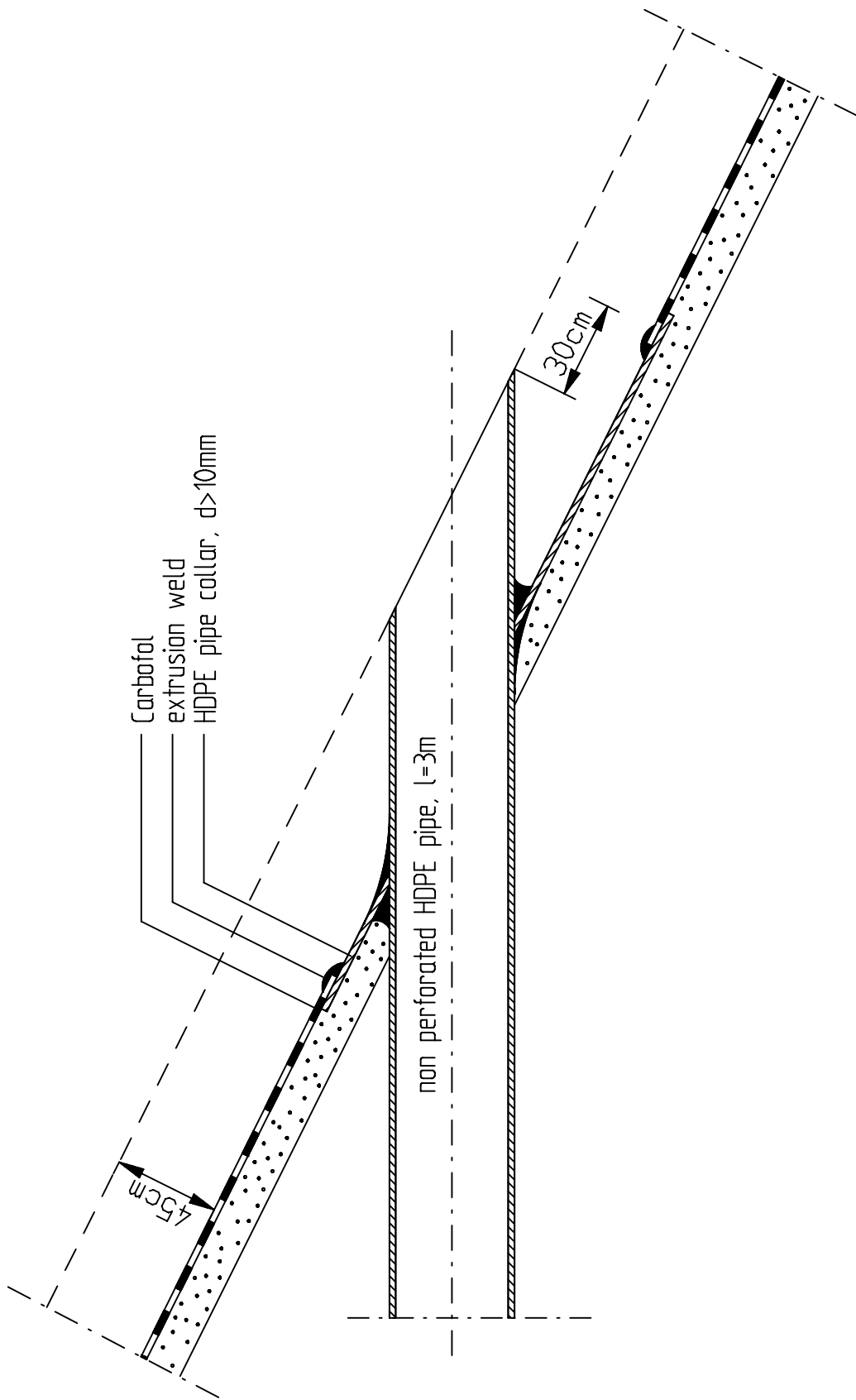

construction unit:

Sealing HDPE pipe ($\varnothing < 300\text{mm}$) penetration through Carbofol

drawing no.:

BBG 007E

horizontal connection

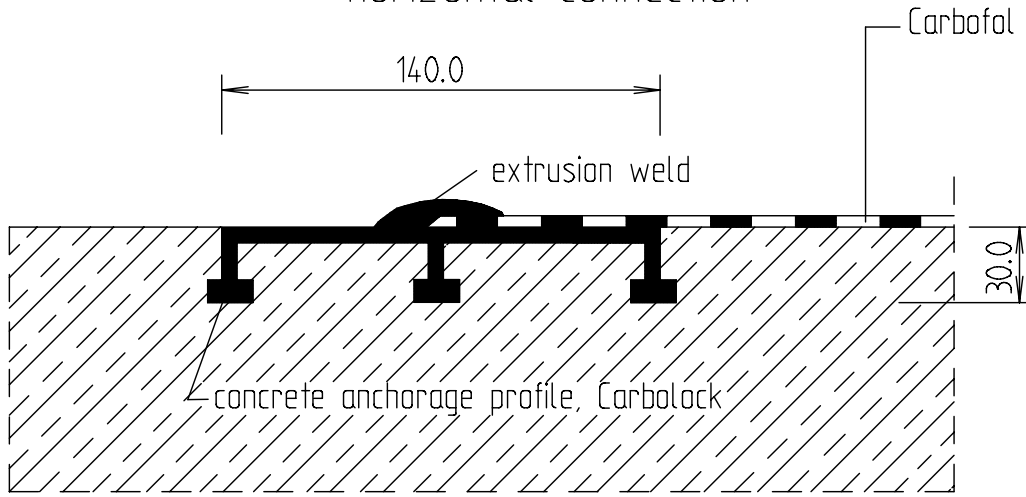

vertical connection

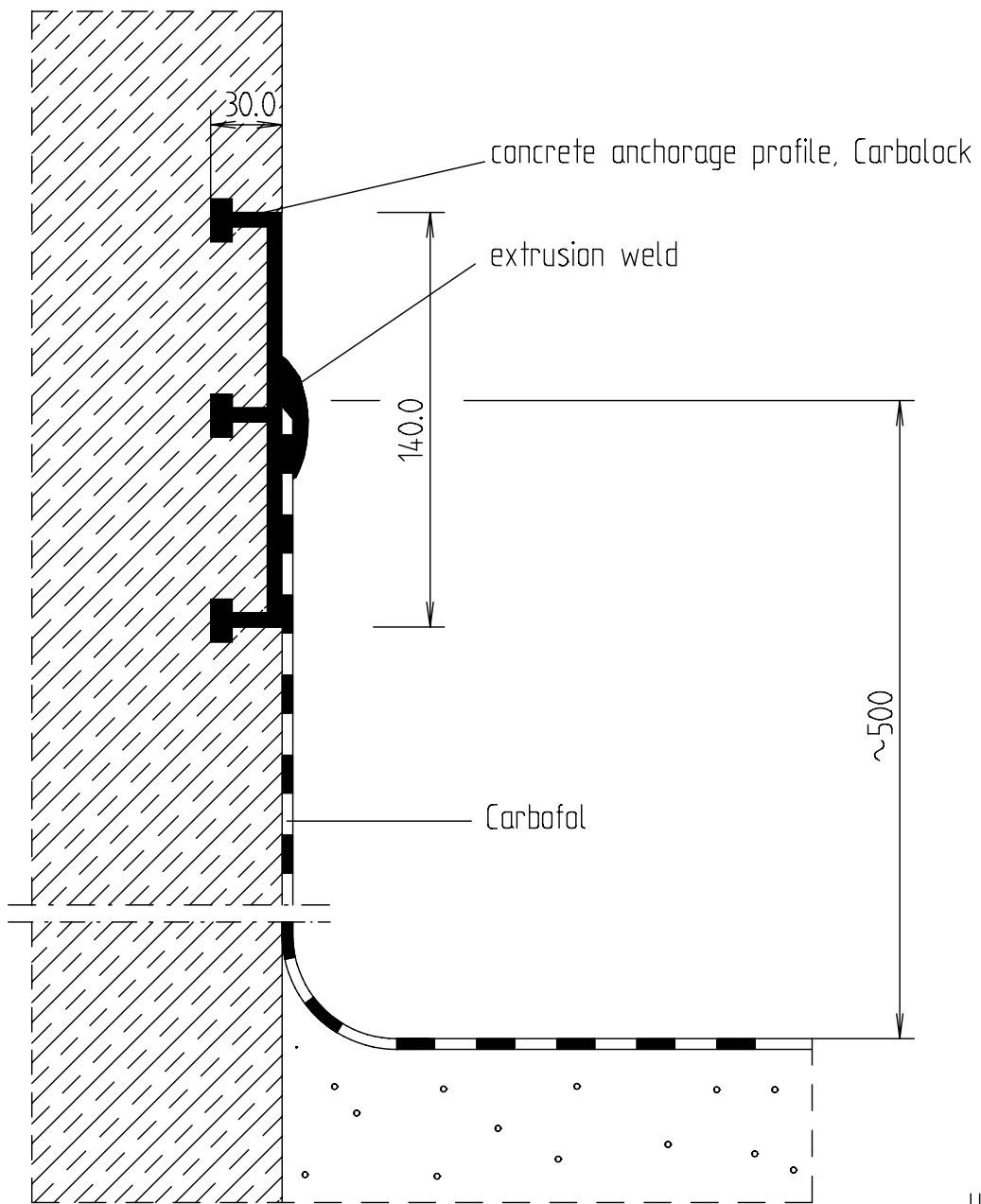

units in mm

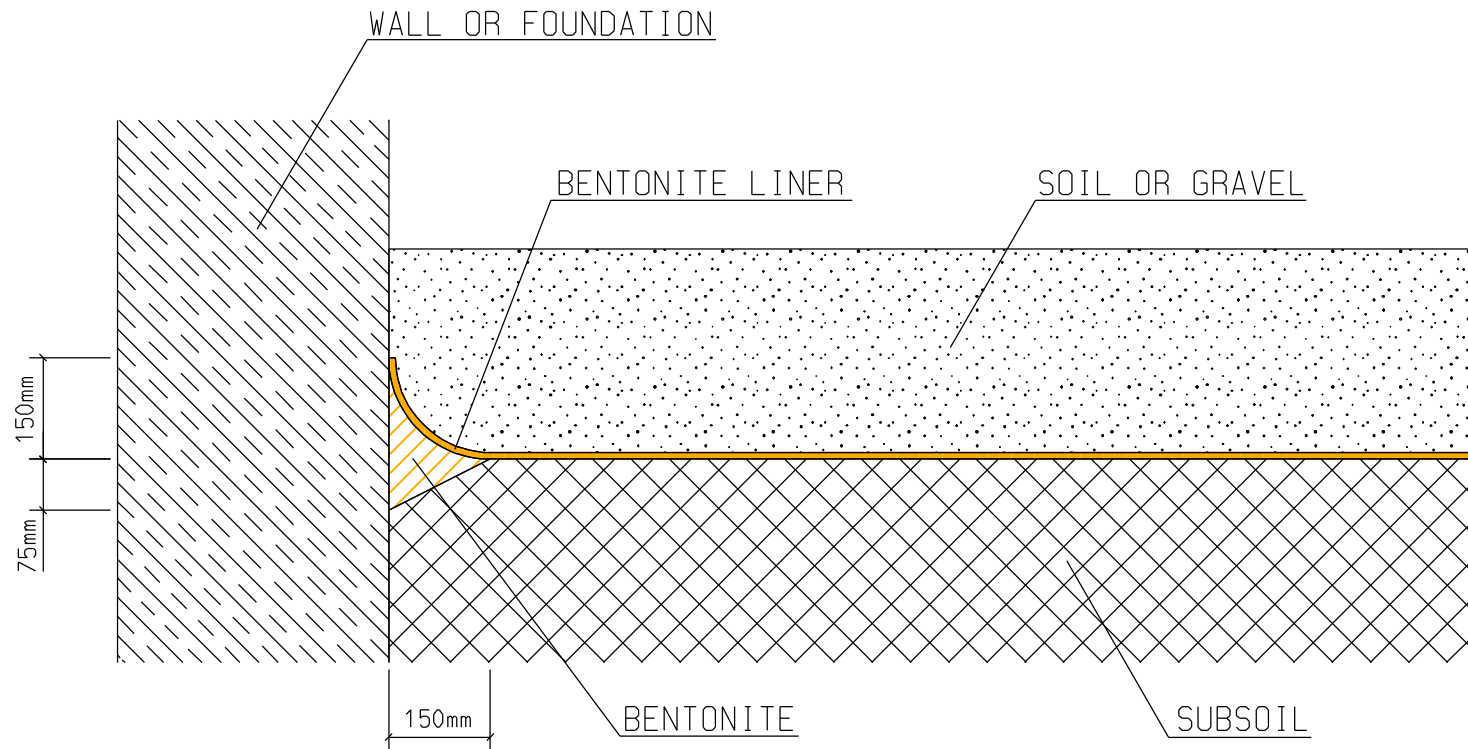

construction unit:

Sealing horizontally installed Bentofix to a
vertical concrete structure

drawing no. :

VE/19-0304-4

30. 03. 2004

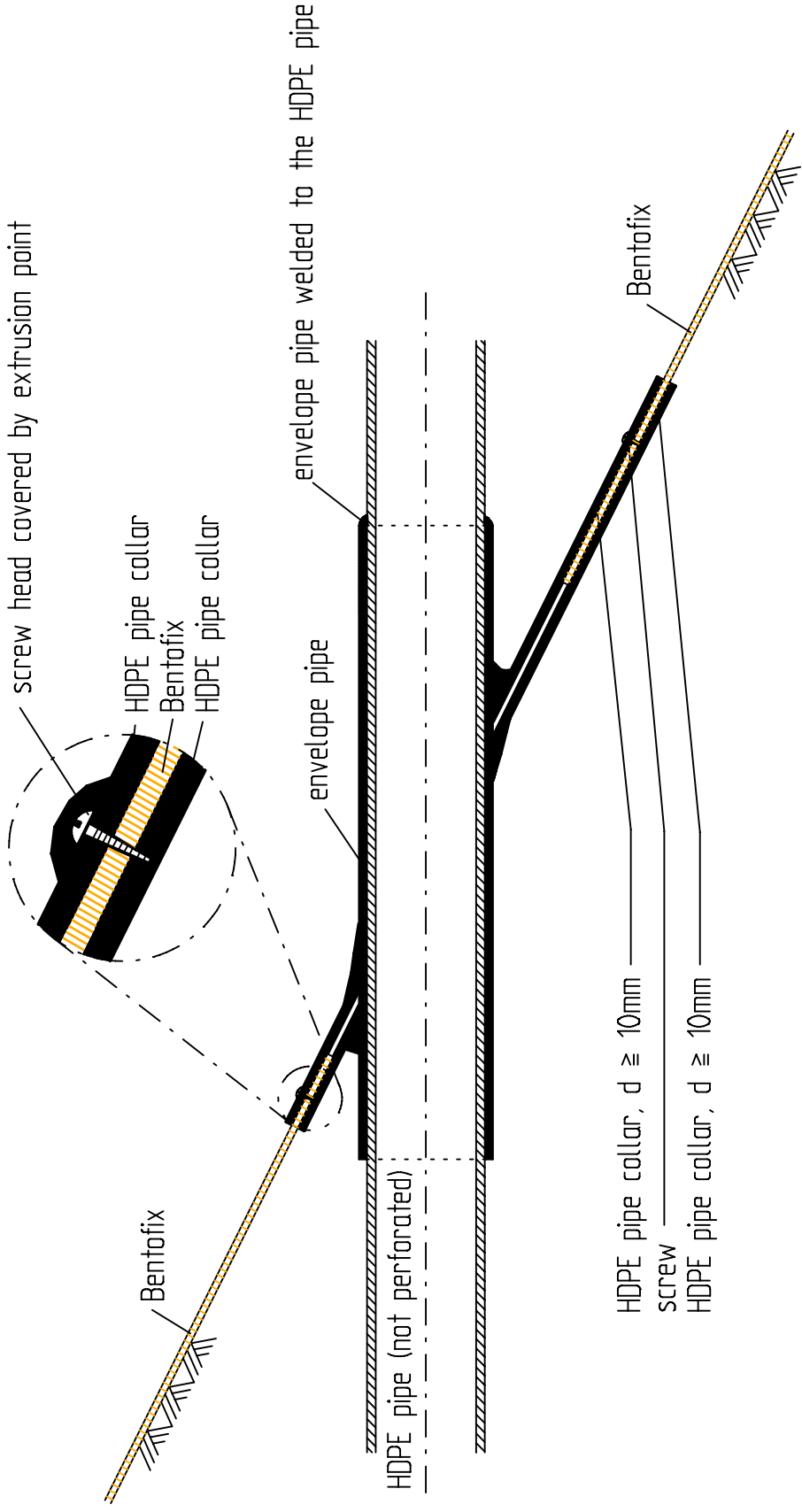

construction unit:

drawing no.: